

SV 363 3p 63A

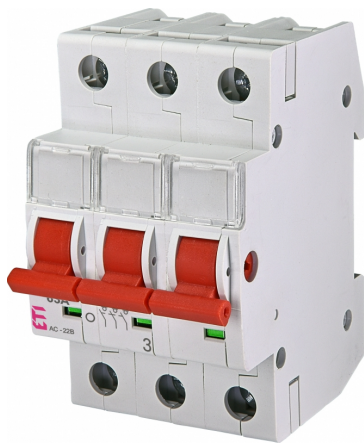

Specifications

ETI Code	002423314
Description	SV 363 3p 63A
Class name	Build-in switch
Function	Build-in switch
Rated current (A)	63

[Online product page](#) 

Other documentation



[Technical data catalogue](#)

[3D Model](#)

[CE declaration](#)

[Eplan file](#)

ETIM international classification

Classification	EC000216
Class name	Switch disconnecter
Version as main switch	1
Version as maintenance-/service switch	1
Version as safety switch	1
Version as emergency stop installation	1
Max. rated operation voltage Ue AC	400V
Rated permanent current Iu	63A
Conditioned rated short-circuit current Iq	4kA
Number of poles	3
Motor drive optional	
Motor drive integrated	
Device construction	Built-in device fixed built-in technique
Suitable for distribution board installation	1
Type of control element	Rocker lever
Interlockable	
Type of electrical connection of main circuit	Frame clamp
Degree of protection (IP), front side	IP20

Dimension drawing

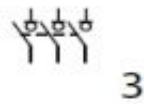
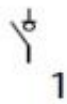
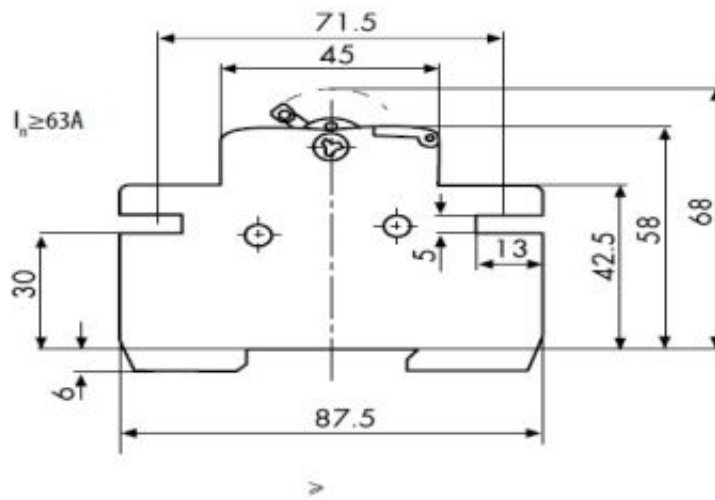

Symbol/Connection

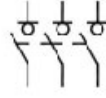
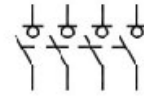
**2****3****4**